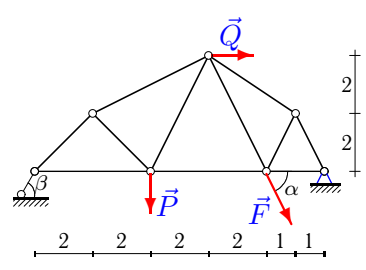
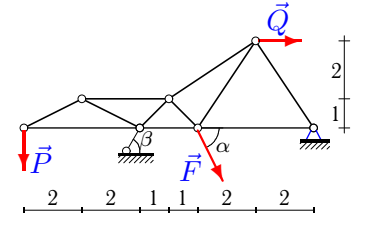
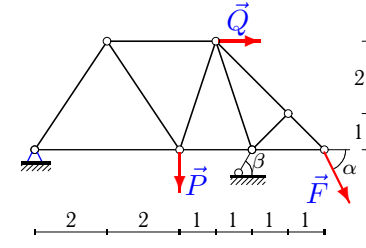
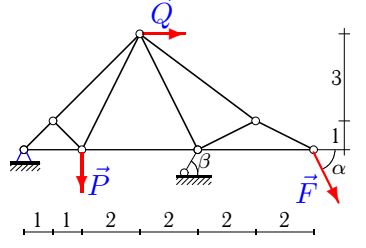
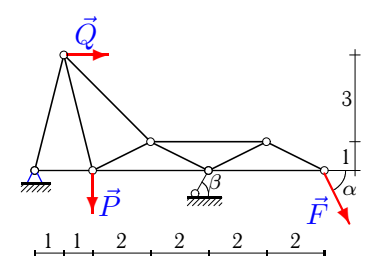
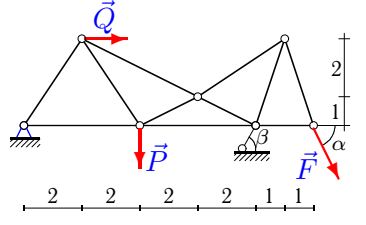
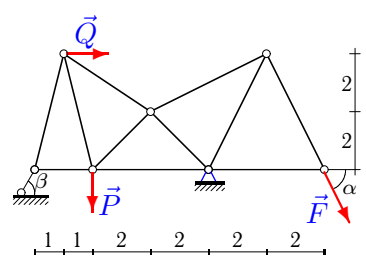
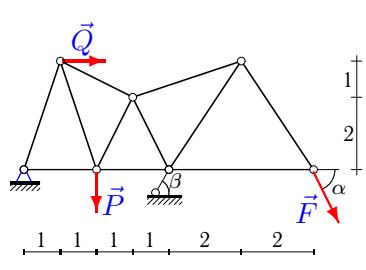
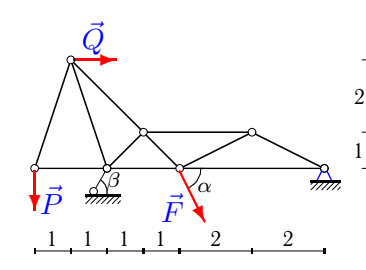
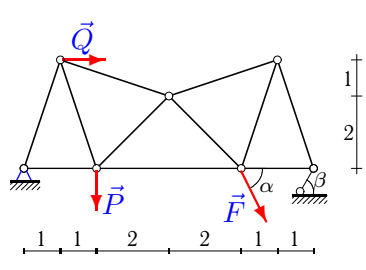

Расчет фермы (треугольная решетка)

Найти усилия в стержнях плоской фермы. Размеры даны в метрах.

Кирсанов М.Н. **Решebник. Теоретическая механика**/Под ред. А. И. Кириллова.– М.: ФИЗМАТЛИТ, 2008. – 384 с. (с.45.)

<p>Задача S6.1. <i>Багаев Евгений</i></p>  <p style="text-align: right;"> $P = 25$ кН, $F = 6$ кН, $Q = 30$ кН, $\alpha = 55^\circ$, $\beta = 45^\circ$. </p>	<p>Задача S6.2. <i>Близнюков Егор</i></p>  <p style="text-align: right;"> $P = 45$ кН, $F = 15$ кН, $Q = 50$ кН, $\alpha = 75^\circ$, $\beta = 60^\circ$. </p>
<p>Задача S6.3. <i>Дударев Евгений</i></p>  <p style="text-align: right;"> $P = 45$ кН, $F = 16$ кН, $Q = 10$ кН, $\alpha = 75^\circ$, $\beta = 60^\circ$. </p>	<p>Задача S6.4. <i>Дудка Иван</i></p>  <p style="text-align: right;"> $P = 5$ кН, $F = 1$ кН, $Q = 60$ кН, $\alpha = 35^\circ$, $\beta = 30^\circ$. </p>
<p>Задача S6.5. <i>Исаев Юрий</i></p>  <p style="text-align: right;"> $P = 20$ кН, $F = 31$ кН, $Q = 60$ кН, $\alpha = 50^\circ$, $\beta = 45^\circ$. </p>	<p>Задача S6.6. <i>Кудрявцев Павел</i></p>  <p style="text-align: right;"> $P = 5$ кН, $F = 18$ кН, $Q = 30$ кН, $\alpha = 35^\circ$, $\beta = 30^\circ$. </p>
<p>Задача S6.7. <i>Кузин Максим</i></p>  <p style="text-align: right;"> $P = 10$ кН, $F = 33$ кН, $Q = 60$ кН, $\alpha = 40^\circ$, $\beta = 30^\circ$. </p>	<p>Задача S6.8. <i>Лещенко Максим</i></p>  <p style="text-align: right;"> $P = 20$ кН, $F = 1$ кН, $Q = 40$ кН, $\alpha = 50^\circ$, $\beta = 45^\circ$. </p>
<p>Задача S6.9. <i>Лутохин Марк</i></p>  <p style="text-align: right;"> $P = 25$ кН, $F = 12$ кН, $Q = 40$ кН, $\alpha = 55^\circ$, $\beta = 45^\circ$. </p>	<p>Задача S6.10. <i>Лысов Сергей</i></p>  <p style="text-align: right;"> $P = 30$ кН, $F = 9$ кН, $Q = 20$ кН, $\alpha = 60^\circ$, $\beta = 45^\circ$. </p>

Задача S6.11.

Макаров Дмитрий

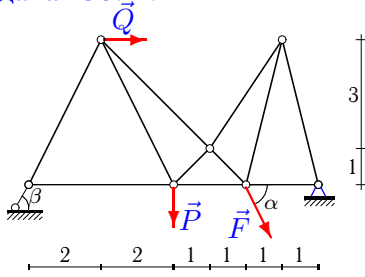

$$P = 10 \text{ кН},$$

$$F = 27 \text{ кН},$$

$$Q = 10 \text{ кН},$$

$$\alpha = 40^\circ,$$

$$\beta = 30^\circ.$$

Задача S6.12.

Миляев Роман

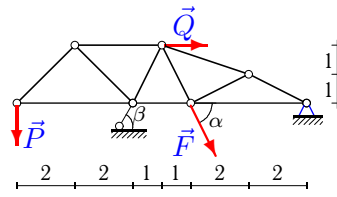

$$P = 40 \text{ кН},$$

$$F = 30 \text{ кН},$$

$$Q = 50 \text{ кН},$$

$$\alpha = 70^\circ,$$

$$\beta = 60^\circ.$$

Задача S6.13.

Однорог Дмитрий

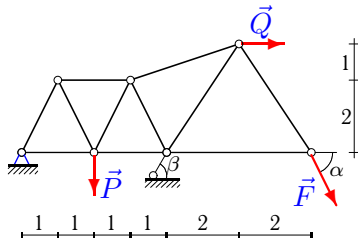

$$P = 25 \text{ кН},$$

$$F = 13 \text{ кН},$$

$$Q = 40 \text{ кН},$$

$$\alpha = 55^\circ,$$

$$\beta = 45^\circ.$$

Задача S6.14.

Петров Михаил

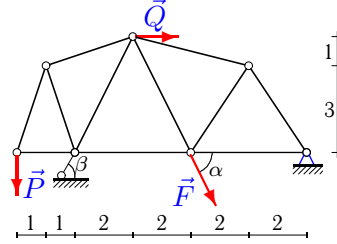

$$P = 10 \text{ кН},$$

$$F = 19 \text{ кН},$$

$$Q = 60 \text{ кН},$$

$$\alpha = 40^\circ,$$

$$\beta = 30^\circ.$$

Задача S6.15.

Потемкин Дмитрий

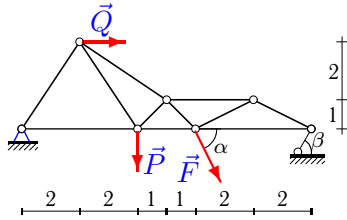

$$P = 25 \text{ кН},$$

$$F = 27 \text{ кН},$$

$$Q = 50 \text{ кН},$$

$$\alpha = 55^\circ,$$

$$\beta = 45^\circ.$$

Задача S6.16.

Пучков Антон

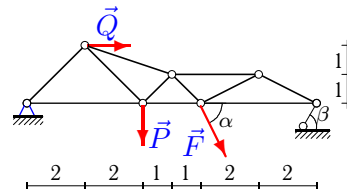

$$P = 10 \text{ кН},$$

$$F = 20 \text{ кН},$$

$$Q = 50 \text{ кН},$$

$$\alpha = 40^\circ,$$

$$\beta = 30^\circ.$$

Задача S6.17.

Пучков Павел

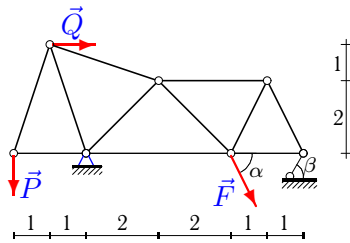

$$P = 15 \text{ кН},$$

$$F = 28 \text{ кН},$$

$$Q = 20 \text{ кН},$$

$$\alpha = 45^\circ,$$

$$\beta = 30^\circ.$$

Задача S6.18.

Самыгина Елизавета

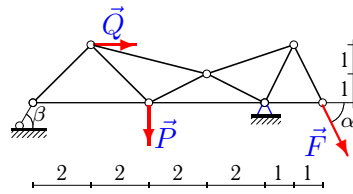

$$P = 10 \text{ кН},$$

$$F = 19 \text{ кН},$$

$$Q = 30 \text{ кН},$$

$$\alpha = 40^\circ,$$

$$\beta = 30^\circ.$$

Задача S6.19.

Теуважуков Антон

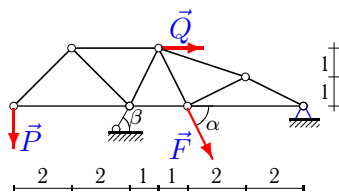

$$P = 25 \text{ кН},$$

$$F = 19 \text{ кН},$$

$$Q = 50 \text{ кН},$$

$$\alpha = 55^\circ,$$

$$\beta = 45^\circ.$$

Задача S6.20.

Туманов Николай

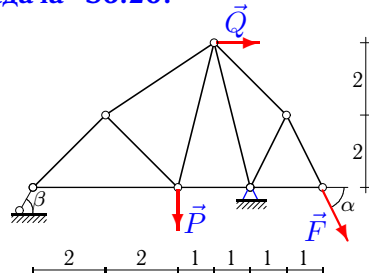

$$P = 35 \text{ кН},$$

$$F = 25 \text{ кН},$$

$$Q = 10 \text{ кН},$$

$$\alpha = 65^\circ,$$

$$\beta = 45^\circ.$$

Задача S6.21.

Улановский Олег

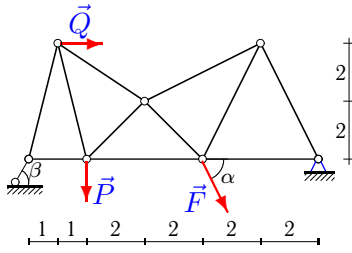

$P = 40 \text{ кН},$
 $F = 13 \text{ кН},$
 $Q = 60 \text{ кН},$
 $\alpha = 70^\circ,$
 $\beta = 60^\circ.$

Задача S6.22.

Хуан Хуань

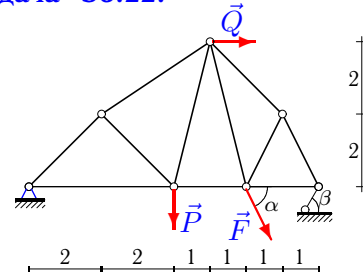

$P = 10 \text{ кН},$
 $F = 4 \text{ кН},$
 $Q = 10 \text{ кН},$
 $\alpha = 40^\circ,$
 $\beta = 30^\circ.$

Задача S6.23.

Чамлай Кирилл

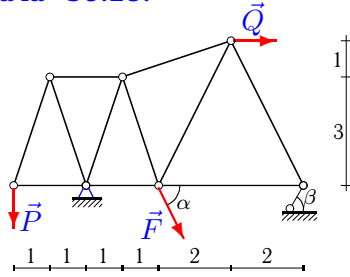

$P = 45 \text{ кН},$
 $F = 3 \text{ кН},$
 $Q = 40 \text{ кН},$
 $\alpha = 75^\circ,$
 $\beta = 60^\circ.$

Задача S6.24.

Ярцев Константин

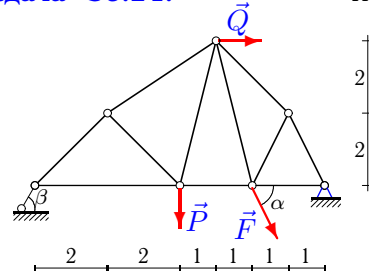

$P = 5 \text{ кН},$
 $F = 6 \text{ кН},$
 $Q = 10 \text{ кН},$
 $\alpha = 35^\circ,$
 $\beta = 30^\circ.$

Задача S6.25.

Ольховский Иван

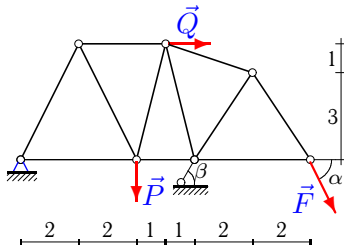

$P = 40 \text{ кН},$
 $F = 4 \text{ кН},$
 $Q = 50 \text{ кН},$
 $\alpha = 70^\circ,$
 $\beta = 60^\circ.$