

# Расчет статически неопределимой фермы

Найти реакции опор фермы.

**Задача М8.1.**

*Абзианидзе Габриел*

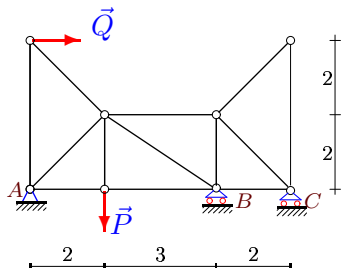

$P = 7 \text{ кН},$   
 $Q = 5 \text{ кН}.$

**Задача М8.2.**

*Авдонин Антон*

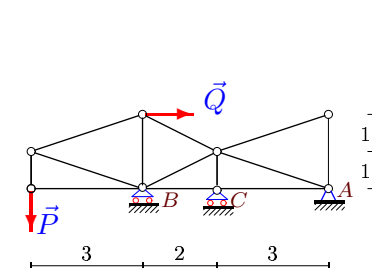

$P = 13 \text{ кН},$   
 $Q = 6 \text{ кН}.$

**Задача М8.3.**

*Белов Виктор*

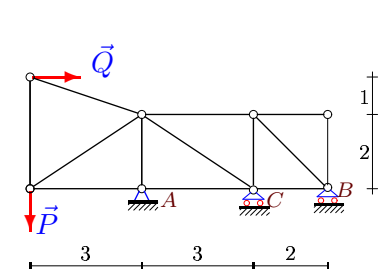

$P = 11 \text{ кН},$   
 $Q = 7 \text{ кН}.$

**Задача М8.4.**

*Болотина Татьяна*

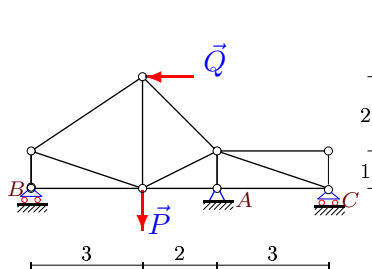

$P = 10 \text{ кН},$   
 $Q = 4 \text{ кН}.$

**Задача М8.5.**

*Бубнова Ольга*

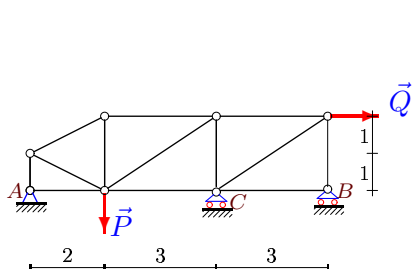

$P = 5 \text{ кН},$   
 $Q = 6 \text{ кН}.$

**Задача М8.6.**

*Глушников Павел*

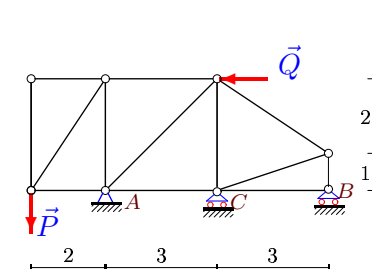

$P = 9 \text{ кН},$   
 $Q = 3 \text{ кН}.$

**Задача М8.7.**

*Горьков Ярослав*

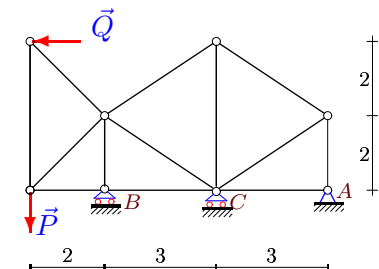

$P = 12 \text{ кН},$   
 $Q = 9 \text{ кН}.$

**Задача М8.8.**

*Комарова Анастасия*

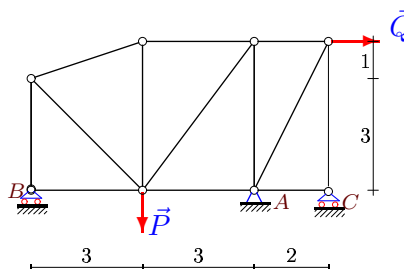

$P = 10 \text{ кН},$   
 $Q = 3 \text{ кН}.$

**Задача М8.9.**

*Конева Наталья*

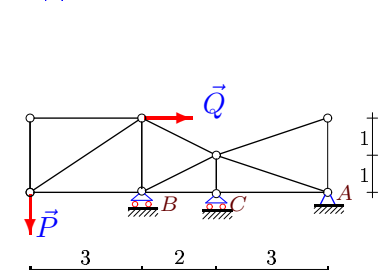

$P = 6 \text{ кН},$   
 $Q = 9 \text{ кН}.$

**Задача М8.10.**

*Любимов Артур*

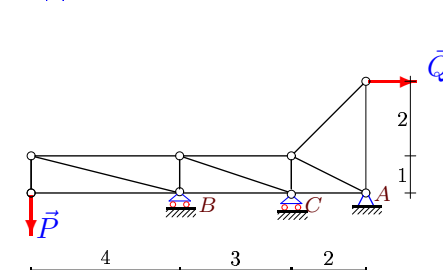

$P = 11 \text{ кН},$   
 $Q = 9 \text{ кН}.$

Задача M8.11.

Мартъянова Мария

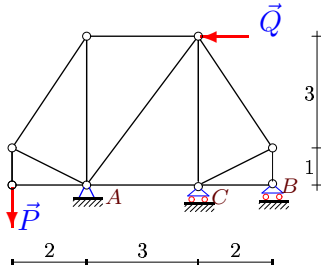

$$P = 12 \text{ кН},$$

$$Q = 3 \text{ кН}.$$

Задача M8.12.

Пилягина Любовь

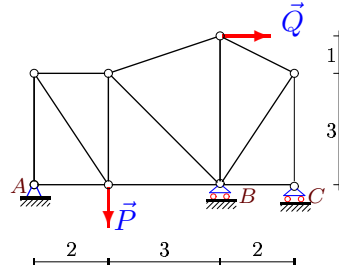

$$P = 11 \text{ кН},$$

$$Q = 6 \text{ кН}.$$

Задача M8.13.

Понамарева Мария

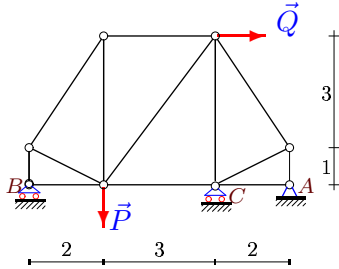

$$P = 6 \text{ кН},$$

$$Q = 4 \text{ кН}.$$

Задача M8.14.

Соколова Елена

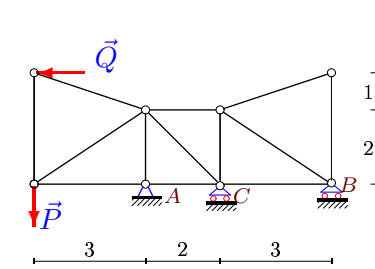

$$P = 7 \text{ кН},$$

$$Q = 8 \text{ кН}.$$

Задача M8.15.

Федоренкова Ольга

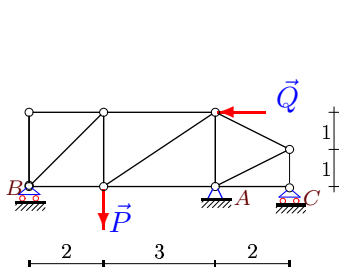

$$P = 8 \text{ кН},$$

$$Q = 6 \text{ кН}.$$

Задача M8.16.

Чыонг Тхи Лан Нхи

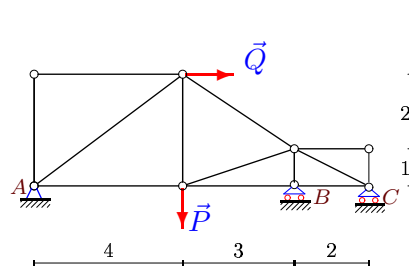

$$P = 5 \text{ кН},$$

$$Q = 4 \text{ кН}.$$

Задача M8.17.

Шипаева Алена

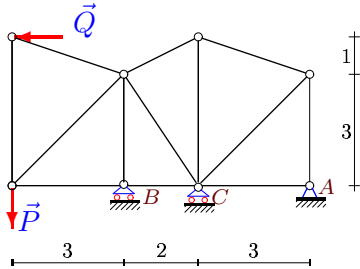

$$P = 10 \text{ кН},$$

$$Q = 9 \text{ кН}.$$

Задача M8.18.

Ямалетдинова Эльвира

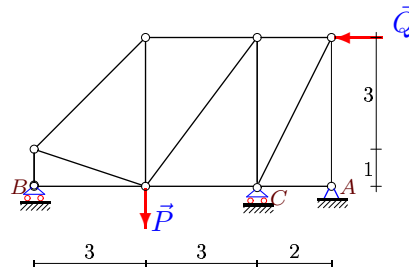

$$P = 6 \text{ кН},$$

$$Q = 5 \text{ кН}.$$

Задача M8.19.

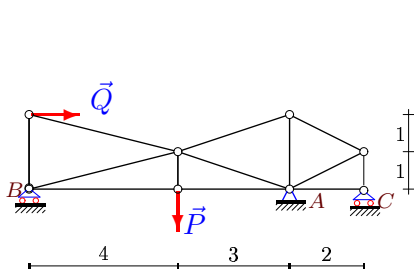

$$P = 12 \text{ кН},$$

$$Q = 9 \text{ кН}.$$

Задача M8.20.

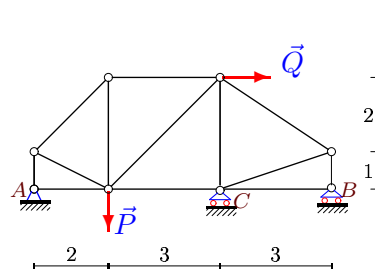

$$P = 12 \text{ кН},$$

$$Q = 8 \text{ кН}.$$

Задача М8.21.

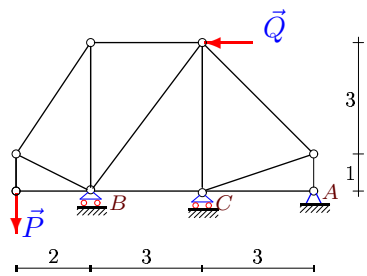

$P = 7 \text{ кН},$   
 $Q = 4 \text{ кН}.$

Задача М8.22.

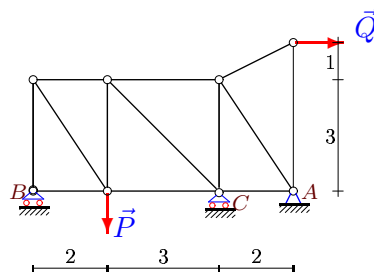

$P = 13 \text{ кН},$   
 $Q = 4 \text{ кН}.$