

Расчет статически неопределимой фермы

Найти реакции опор фермы.

Задача М8.1.

Акалаев Эмран

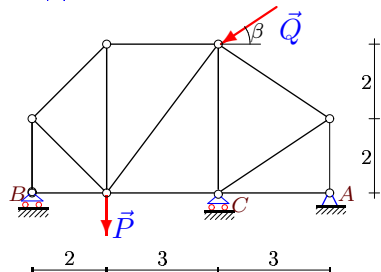

$$P = 5 \text{ кН},$$

$$Q = 9 \text{ кН},$$

$$\beta = 30^\circ.$$

Задача М8.2.

Бровка Татьяна

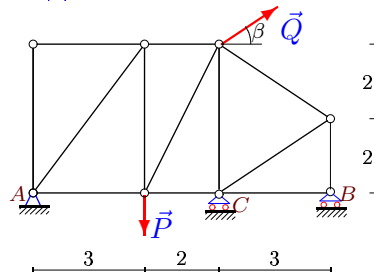

$$P = 5 \text{ кН},$$

$$Q = 9 \text{ кН},$$

$$\beta = 30^\circ.$$

Задача М8.3.

Бутняков Марк

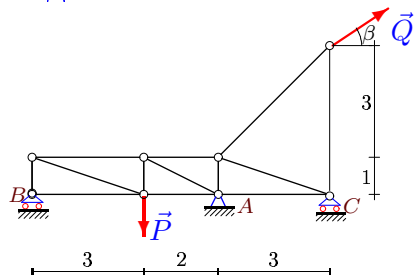

$$P = 6 \text{ кН},$$

$$Q = 5 \text{ кН},$$

$$\beta = 45^\circ.$$

Задача М8.4.

Васильева Наталья

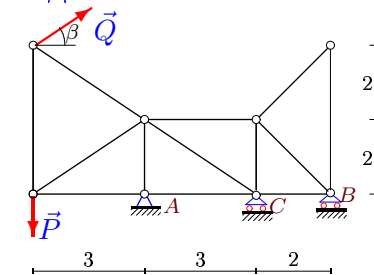

$$P = 7 \text{ кН},$$

$$Q = 8 \text{ кН},$$

$$\beta = 30^\circ.$$

Задача М8.5.

Величко Валерия

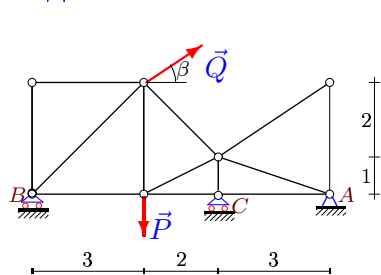

$$P = 7 \text{ кН},$$

$$Q = 4 \text{ кН},$$

$$\beta = 30^\circ.$$

Задача М8.6.

Глухов Олег

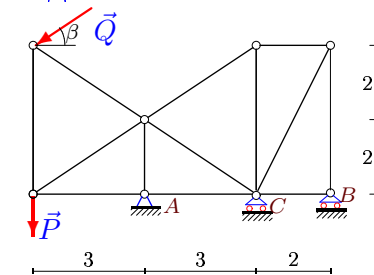

$$P = 8 \text{ кН},$$

$$Q = 4 \text{ кН},$$

$$\beta = 15^\circ.$$

Задача М8.7.

Гуцин Алексей

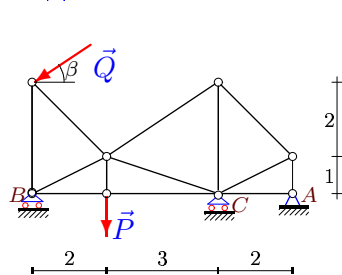

$$P = 10 \text{ кН},$$

$$Q = 6 \text{ кН},$$

$$\beta = 15^\circ.$$

Задача М8.8.

Зеленецкий Кирилл

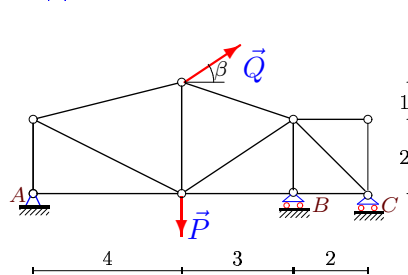

$$P = 10 \text{ кН},$$

$$Q = 5 \text{ кН},$$

$$\beta = 15^\circ.$$

Задача М8.9.

Зинин Иван

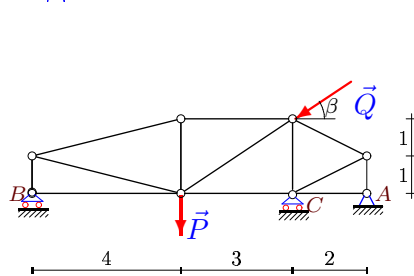

$$P = 9 \text{ кН},$$

$$Q = 5 \text{ кН},$$

$$\beta = 45^\circ.$$

Задача М8.10.

Иванова Анна

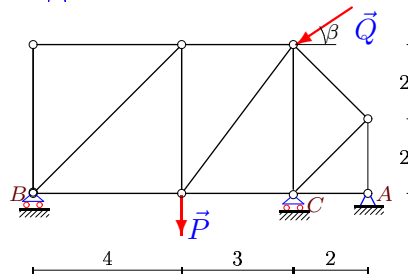

$$P = 11 \text{ кН},$$

$$Q = 4 \text{ кН},$$

$$\beta = 30^\circ.$$

Задача M8.11.

Кухарук Екатерина

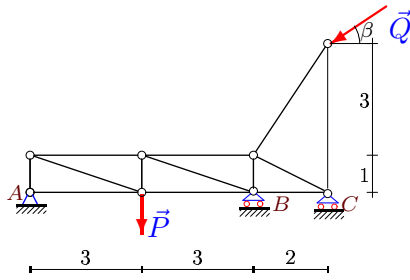

$P = 12 \text{ кН},$
 $Q = 7 \text{ кН},$
 $\beta = 45^\circ.$

Задача M8.12.

Лобус Александр

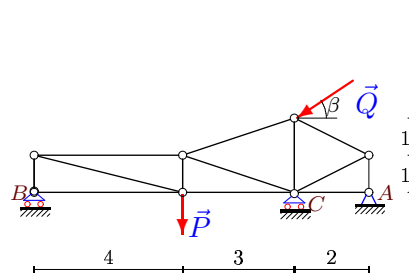

$P = 12 \text{ кН},$
 $Q = 8 \text{ кН},$
 $\beta = 45^\circ.$

Задача M8.13.

Лутченкова Екатерина

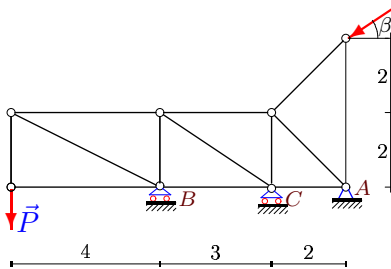

$P = 9 \text{ кН},$
 $Q = 5 \text{ кН},$
 $\beta = 30^\circ.$

Задача M8.14.

Лысенко Наталья

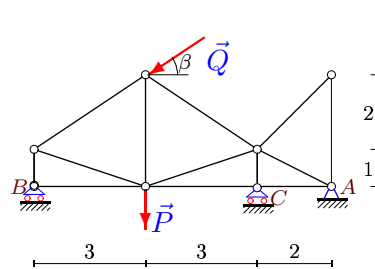

$P = 6 \text{ кН},$
 $Q = 5 \text{ кН},$
 $\beta = 30^\circ.$

Задача M8.15.

Маругина Ксения

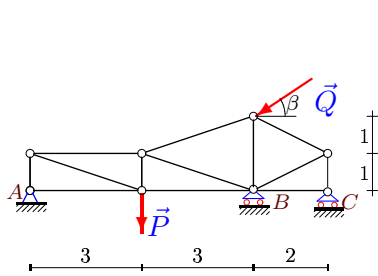

$P = 12 \text{ кН},$
 $Q = 4 \text{ кН},$
 $\beta = 45^\circ.$

Задача M8.16.

Мишонкова Ксения

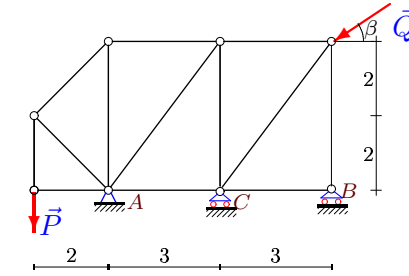

$P = 6 \text{ кН},$
 $Q = 5 \text{ кН},$
 $\beta = 30^\circ.$

Задача M8.17.

Новиков Семён

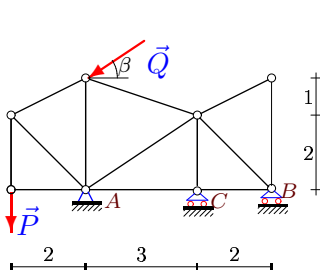

$P = 7 \text{ кН},$
 $Q = 8 \text{ кН},$
 $\beta = 15^\circ.$

Задача M8.18.

Озик Дарья

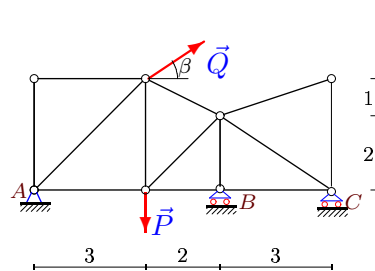

$P = 6 \text{ кН},$
 $Q = 7 \text{ кН},$
 $\beta = 45^\circ.$

Задача M8.19.

Особов Алексей

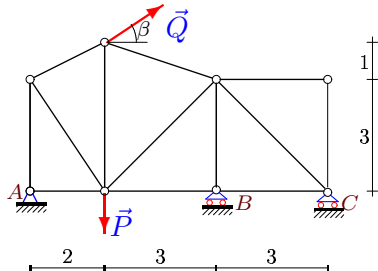

$P = 13 \text{ кН},$
 $Q = 4 \text{ кН},$
 $\beta = 30^\circ.$

Задача M8.20.

Панченков Роман

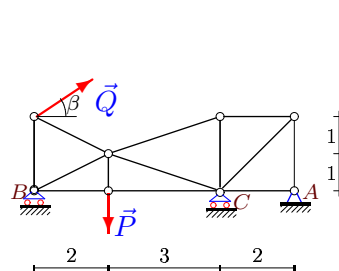

$P = 7 \text{ кН},$
 $Q = 3 \text{ кН},$
 $\beta = 15^\circ.$

Задача M8.21.

Писоцкая Наталья

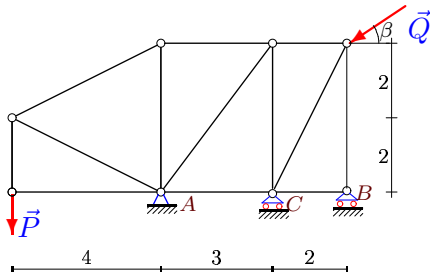

$P = 7 \text{ кН},$
 $Q = 3 \text{ кН},$
 $\beta = 30^\circ.$

Задача M8.22.

Самсонов Евгений

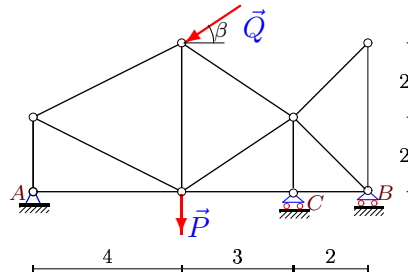

$P = 6 \text{ кН},$
 $Q = 5 \text{ кН},$
 $\beta = 15^\circ.$

Задача M8.23.

Скворцова Светлана

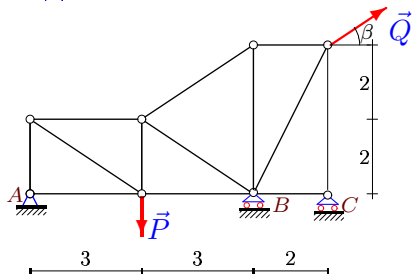

$P = 9 \text{ кН},$
 $Q = 4 \text{ кН},$
 $\beta = 15^\circ.$

Задача M8.24.

Стамболян Станислав

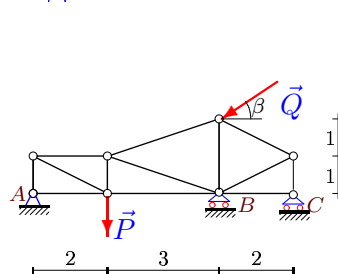

$P = 10 \text{ кН},$
 $Q = 4 \text{ кН},$
 $\beta = 45^\circ.$

Задача M8.25.

Ткачук Георгий

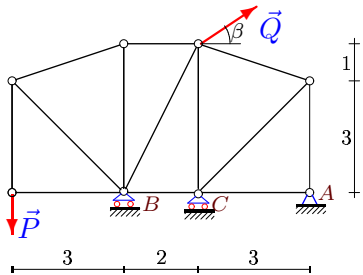

$P = 12 \text{ кН},$
 $Q = 9 \text{ кН},$
 $\beta = 30^\circ.$

Задача M8.26.

Трифонов Илья

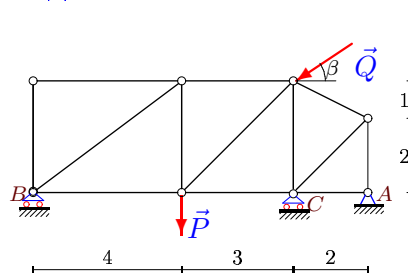

$P = 13 \text{ кН},$
 $Q = 4 \text{ кН},$
 $\beta = 45^\circ.$

Задача M8.27.

Щербакова Анастасия

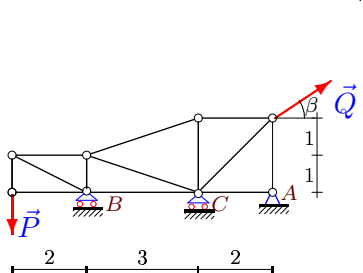

$P = 11 \text{ кН},$
 $Q = 6 \text{ кН},$
 $\beta = 45^\circ.$